

*11.8 [.46"] PRIOR TO THE END OF VERTICAL LIFT, PLATE BEGINS TIPPING MOTION.

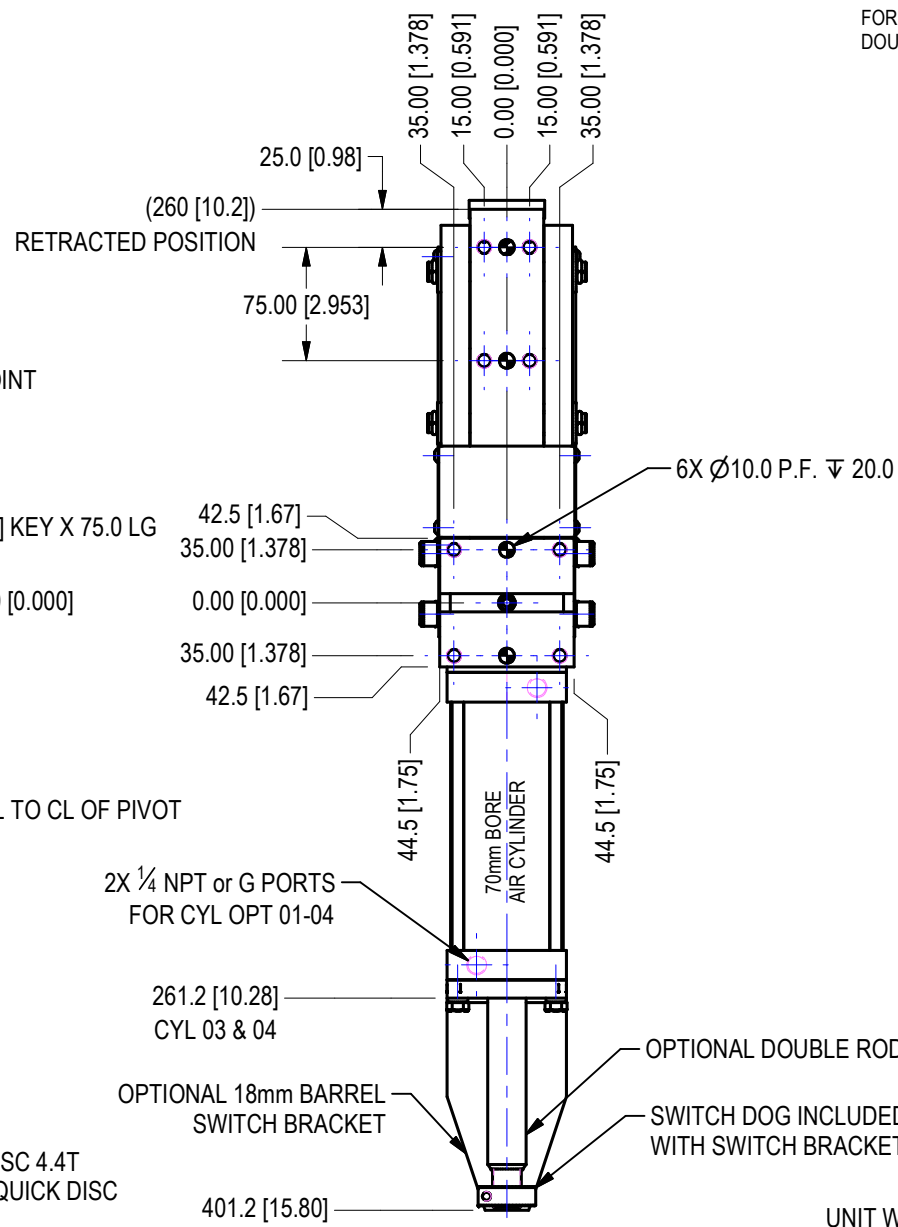
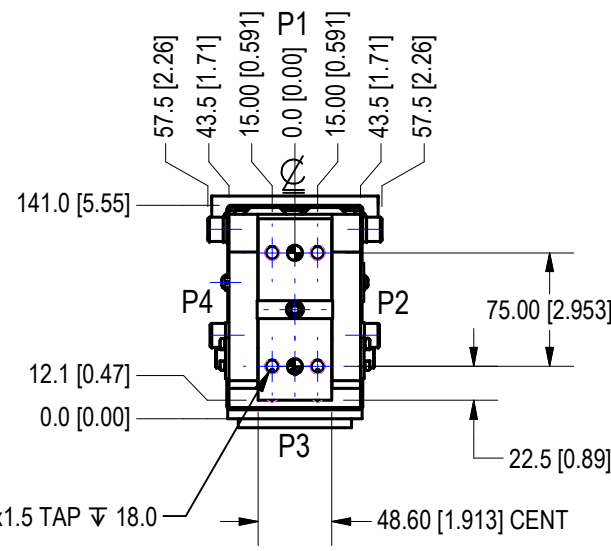
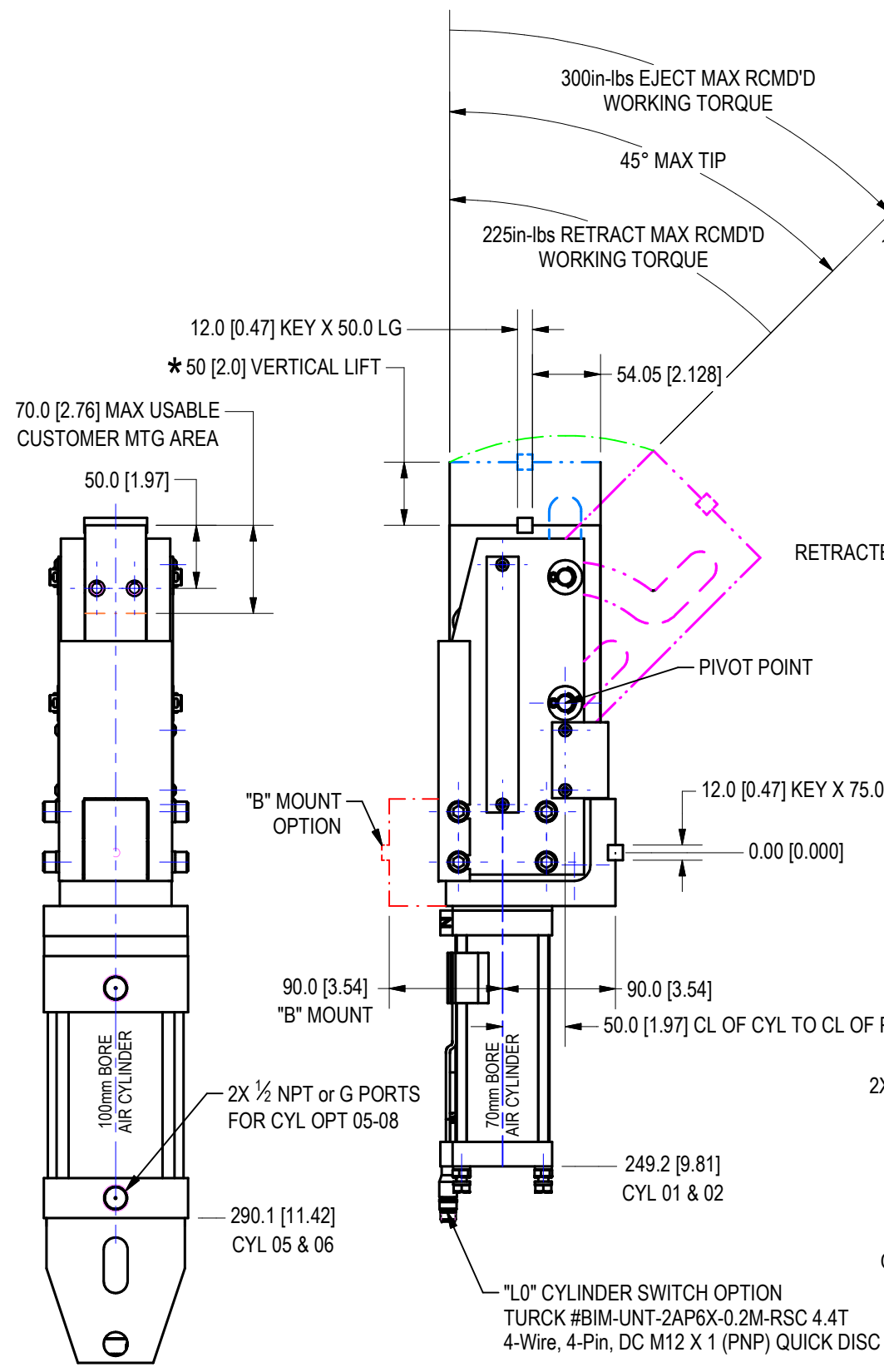

ORDERING INFORMATION

U P E 0 4 5 A 0 1 0 A 0 0 1 A 0 0 0

- Angle**
045 Optional angles: 11, 22, 31, 39 & 45 deg
- Actuator**
01 Welker 70mm Bore w/ NPT Ports
02 Welker 70mm Bore w/ G Ports
03 Welker 70mm Bore DBL Rod w/ NPT Ports
04 Welker 70mm Bore DBL Rod w/ G Ports
05 Welker 100mm Bore w/ NPT Ports
06 Welker 100mm Bore w/ G Ports
07 Welker 100mm Bore DBL Rod w/ NPT Ports
08 Welker 100mm Bore DBL Rod w/ G Ports
- Mount**
A Mounting Base as Shown
B Mounting Base Rotated 180deg
- Port Position**
A Port @ Pos.1 (Shown)
B Port @ Pos.2
C Port @ Pos.3
D Port @ Pos.4
- Sw. Bracket Position**
0 For Sw Opt 00 & L0
1 Bracket @ Pos.1
2 Bracket @ Pos.2
3 Bracket @ Pos.3
4 Bracket @ Pos.4
- Switch Options**
00 No Switching Req'd
L0 Cylinder Switch
01 18mm Barrel Switch Bracket

LOADING CAPACITY:
FOR CYLINDER OPTIONS 01-04:
THE EJECTOR UNIT AT 60psi HAS A VERTICAL LIFTING CAPACITY OF 200lbs WITH AN EJECT MAX RECOMMENDED WORKING TORQUE OF 300in-lbs WHILE THE RETRACT MAX RECOMMENDED WORKING TORQUE IS 225in-lbs. BOTH TORQUES ARE RELATIVE TO THE PIVOT POINT. THE LIFT FORCE AND TORQUES ARE DIRECTLY PROPORTIONAL TO THE AIR PRESSURE.

FOR CYLINDER OPTIONS 05-08:
DOUBLE LIFTING AND TORQUE LOAD CAPACITIES FROM CYL OPT 01-04

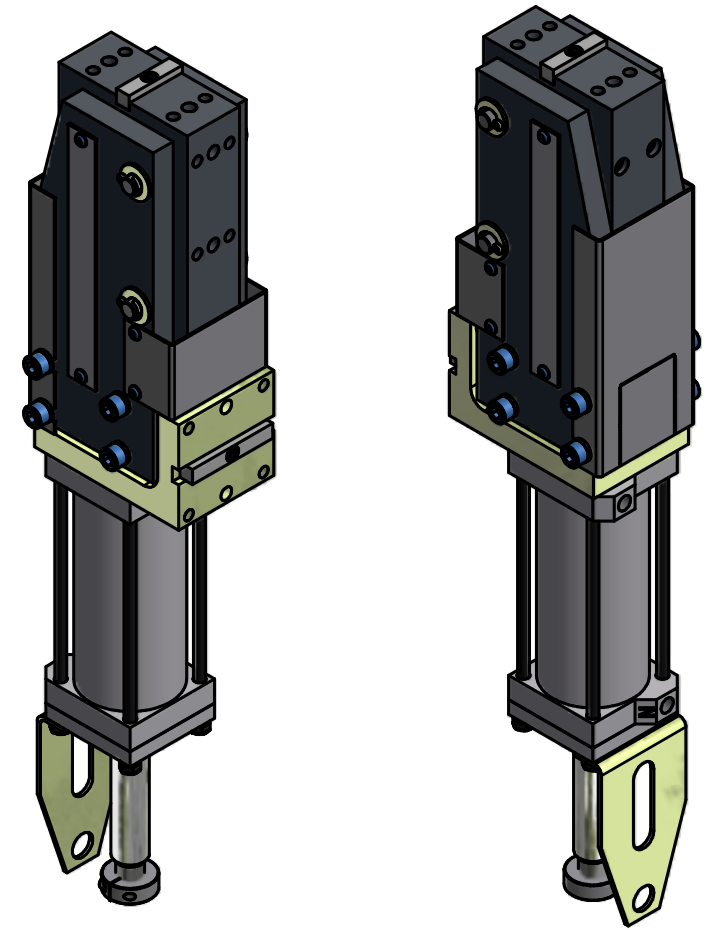

UNITS ARE MILLIMETERS
(i.e.X.XXmm [x.xxx"])
DO NOT SCALE DRAWING

UNIT WEIGHT = APPROX. 51.5 lbs.

WELKER BEARING COMPANY					
TOOL NAME: PART EJECTOR ASSEMBLY					
TEMPLATE					
DATE	STATUS	DRAWN BY	DATE	CHK'D BY	ENG APPROVAL
8/27/2010	Released	DJH	10/9/2011	GSK	
SCALE		N/A		FILE NAME	UPE45L01